

FRONT VIEW

STEP 1

- A. In the corner of the wall, lightly scribe the desired height of the Modex Corner (MDXC.)
- B. Measure and mark the corner at 1.25" below the desired height.
- C. Measure and mark the corner again at 1'9.25" below the first mark.
- D. Center a 3" woodscrew at each mark and sink to the depth of .60" from the head to the inside of the corner.

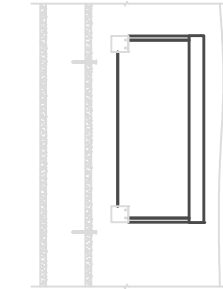
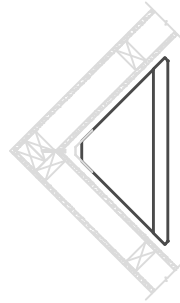

SIDE VIEW (THROUGH LEFT WALL)

STEP 2

- A. Lift the MDXC into position (approx. 1" away from both walls and 1.5" above scribe.)
- B. Being careful not to mar either wall, advance the MDXC inward toward the corner.
- C. Gently slide the MDXC down onto both screws until the unit sets.

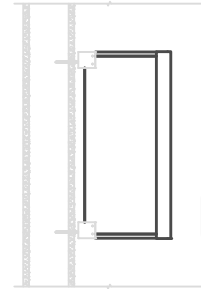
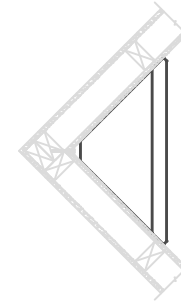

SIDE VIEW (THROUGH LEFT WALL)

STEP 3

- A. An adjustment may be necessary in order to secure a proper fit.
- B. If the screws are sunk too far, they may draw the MDXC in too snug or not allow it to set at all.
- C. If the screws are not sunk enough, they may allow the MDXC to tilt or rattle.
- D. If the screws are not spaced properly, the MDXC may not be secure.



99 SOUTH STREET, PASSAIC, NJ 07055
(P) 973-916-1166 (E) estimating@rpgacoustic.com

Title: *MODEX CORNER WALL MOUNTING DETAIL*

Proj: *RPG PRODUCT*

Date: *4/24/17* By: *ACT* Scale: *NTS*

Path: *F:\Project Mgmt - RPG\...RPG PRODUCTS\ALL PRODUCTS DRAWING\MDXC_Modex Corner\CAD_DWG\MDXC Cutsheet & Mounting*

Comments:
