

S.W. ISOMETRIC

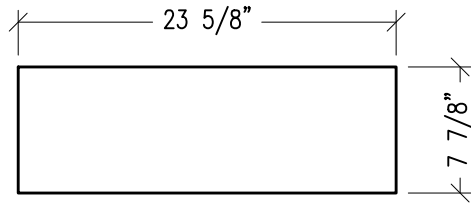

TOP

FINISH TYPE
VENEER

MODF - MODFUSSOR 4'x2' EE
 PARTS FROM " PLYWOOD
 TOP/BOTTOM 2 PCS. @ 7.875"x23.625
 SIDES 2PCS. 7.875"x46.25"
 DIVIDERS 8 PCS. @ VARIES"x46.25"
 WELLS 9 PCS. @ VARIES"x46.25"
 STABILIZER RIB 1 PC. @ 7.875"x23.625"
 (FROM ROUTER)

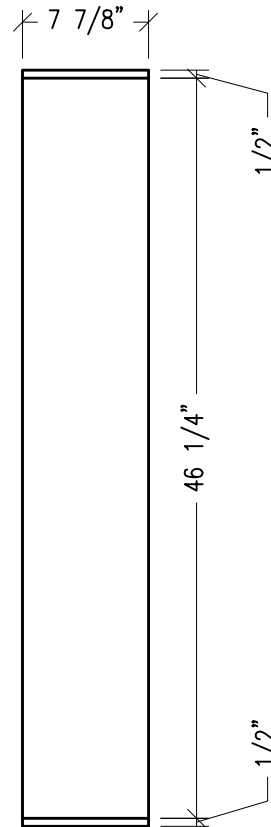

SIDE

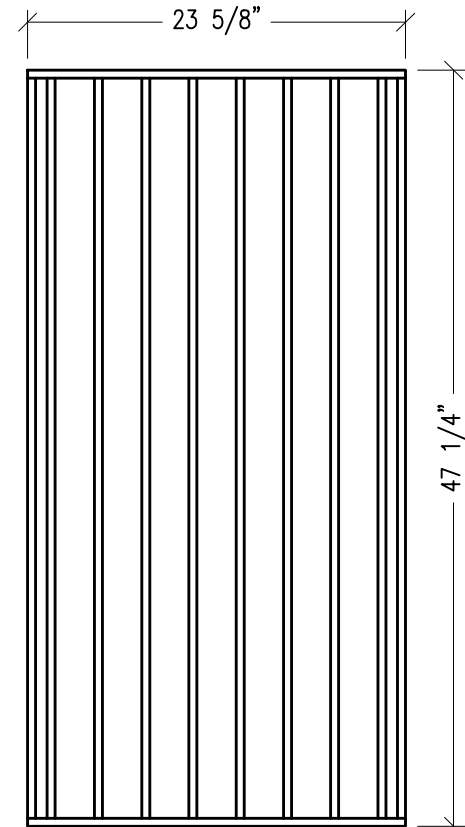

FRONT



ACOUSTICAL SYSTEMS - LLC
 99 SOUTH STREET, PASSAIC, NJ 07055
 (P) 973-916-1166 (E) estimating@rpgacoustic.com

Title: RPG MODFUSSOR 4'x2' EE
 CUTSHEET

Proj: RPG PRODUCT

Date: 8/24/22

By: JLP

Scale: N15

Comments:

Path: F:\Project Mgmt - RPG\ -RPG PRODUCTS\ALL PRODUCTS DRAWING\MODF_Modfussor\1-AutoCAD Drawings\Cutsheet\4x2 EE Cutsheet R1

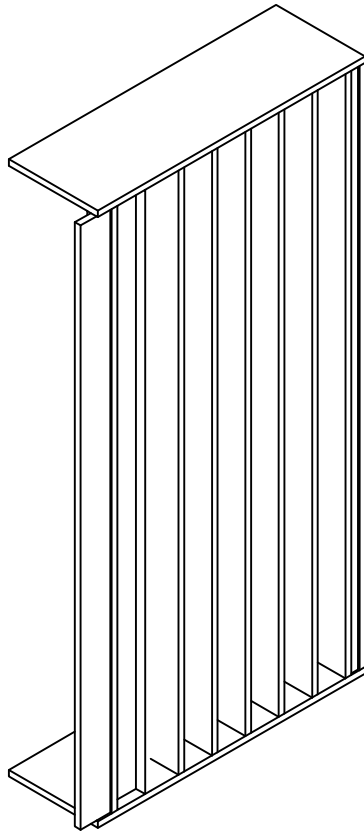

S.W. ISOMETRIC

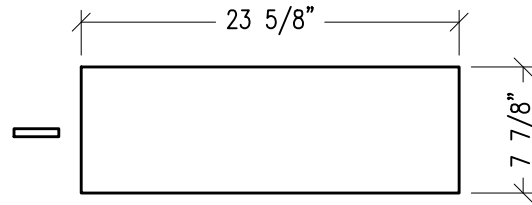

TOP

FINISH TYPE
VENEER

MODF - MODFUSSOR 4'x2' EJO
 PARTS FROM " PLYWOOD
 TOP/BOTTOM 2 PCS. @ 7.875"x23.625"
 SIDES 1PCS. 7.875"x46.25"
 JOINER 1PCS. 2.8125"x46.25"
 DIVIDERS 8 PCS. @ VARIES"x46.25"
 WELLS 8 PCS. @ VARIES"x46.25"
 STABILIZER RIB 1 PC. @ 7.875"x23.625"
 (FROM ROUTER)

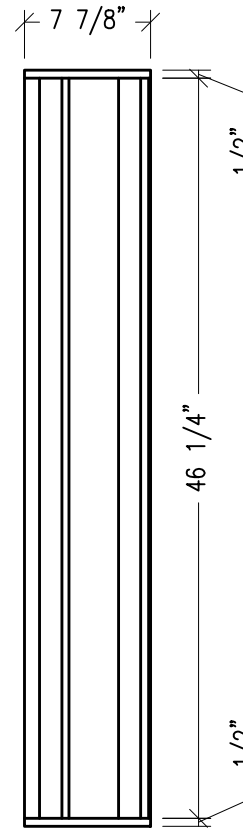

SIDE

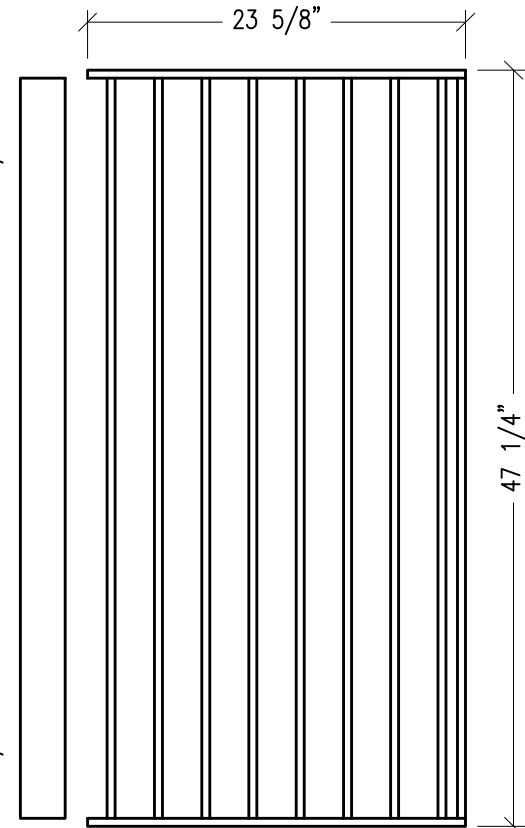

FRONT



99 SOUTH STREET, PASSAIC, NJ 07055
 (P) 973-916-1166 (E) estimating@rpgacoustic.com

Title: RPG MODFUSSOR 4'x2' EJO
 CUTSHEET

Proj: RPG PRODUCT

Date: 8/24/22

By: JLP

Scale: N15

Comments:

Path: F:\Project Mgmt - RPG\PROJECTS\ALL PRODUCTS DRAWING\MODF_Modfusor\1-AutoCAD Drawings\Cutsheet\4x2 EJO Cutsheet.RI

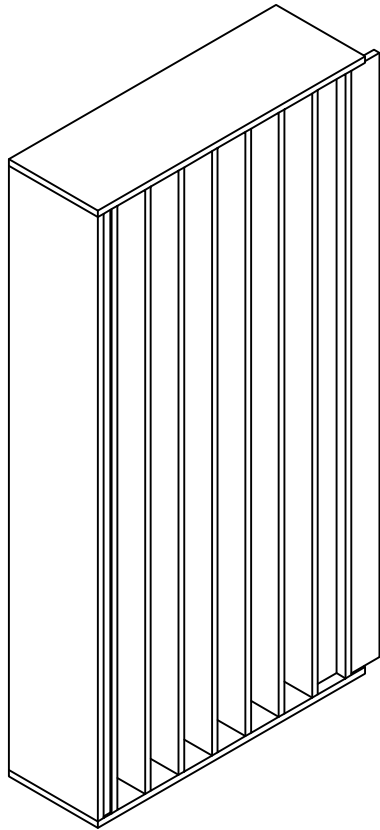

S.W. ISOMETRIC

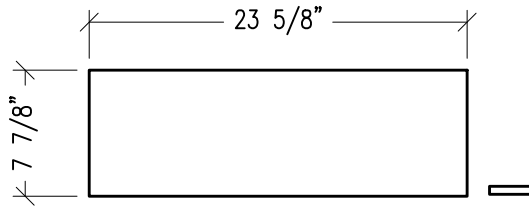

TOP

FINISH TYPE
VENEER

MODF - MODFUSSOR 4'x2' EJ1
 PARTS FROM " PLYWOOD
 TOP/BOTTOM 2 PCS. @ 7.875"x23.625
 SIDES 1PCS. 7.875"x46.25"
 JOINER 1PCS. 2.8125"x46.25"
 DIVIDERS 8 PCS. @ VARIES"x46.25"
 WELLS 8 PCS. @ VARIES"x46.25"
 STABILIZER RIB 1 PC. @ 7.875"x23.625"
 (FROM ROUTER)

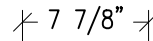

SIDE

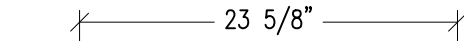

FRONT



99 SOUTH STREET, PASSAIC, NJ 07055
 (P) 973-916-1166 (E) estimating@rpgacoustic.com

Title: RPG MODFUSSOR 4'x2' EJ1
 CUTSHEET

Proj: RPG PRODUCT

Date: 8/24/22

By: JLP

Scale: N15

Comments:

Path: F:\Project Mgmt - RPG\RPG PRODUCTS\ALL PRODUCTS DRAWING\MODF_Modfusor\1-AutoCAD Drawings\Cutsheet\4x2 EJ1 Cutsheet R1

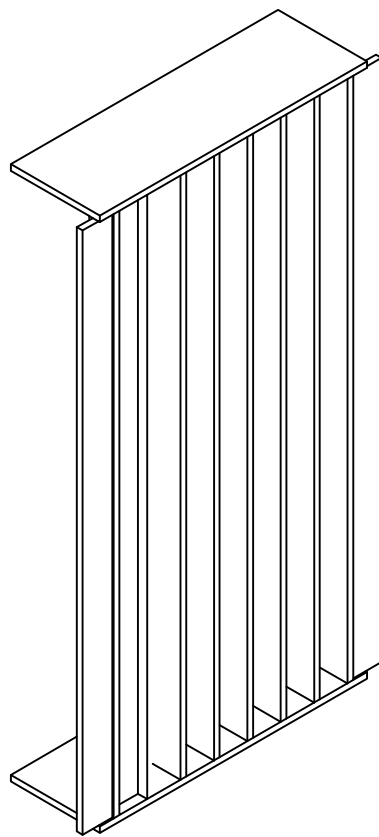

S.W. ISOMETRIC

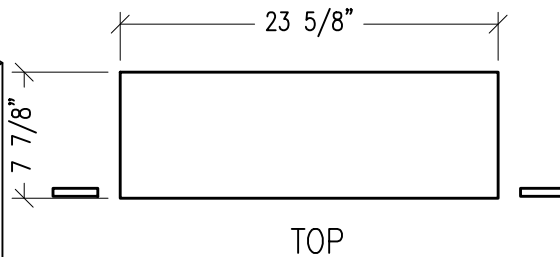

FINISH TYPE
VENEER

MODF - MODFUSSOR 4'x2' JJ
 PARTS FROM " PLYWOOD
 TOP/BOTTOM 2 PCS. @ 7.875"x23.625
 JOINER 2PCS. 2.8125"x46.25"
 DIVIDERS 8 PCS. @ VARIES"x46.25"
 WELLS 7 PCS. @ VARIES"x46.25"
 STABILIZER RIB 1 PC. @ 7.875"x23.625"
 (FROM ROUTER)

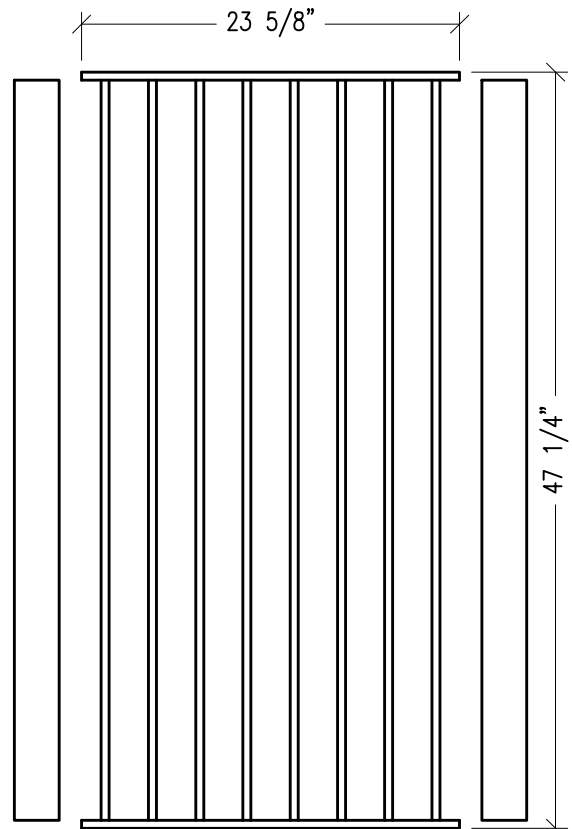
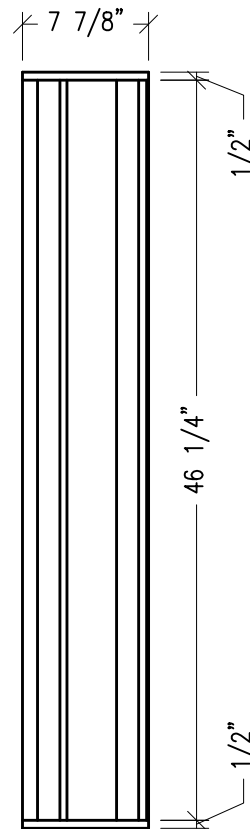

99 SOUTH STREET, PASSAIC, NJ 07055
 (P) 973-916-1166 (E) estimating@rpgacoustic.com

Title: RPG MODFUSSOR 4'x2' JJ
 CUTSHEET

Proj: RPG PRODUCT

Date: 8/24/22

By: JLP

Scale: N15

Comments:

Path: F:\Project Mgmt - RPG\ - RPG PRODUCTS\ALL PRODUCTS DRAWING\MODF_Modffusor\1-AutoCAD Drawings\Cutsheet\4x2 JJ Cutsheet R1

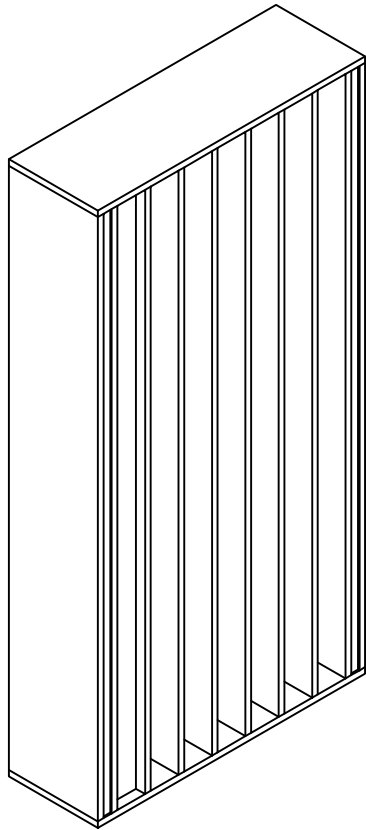

S.W. ISOMETRIC

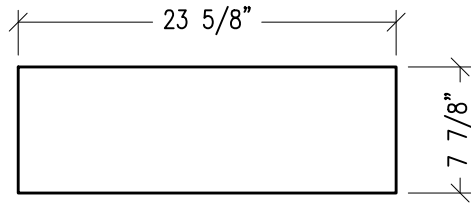

TOP

FINISH TYPE
VENEER

MODF – MODFUSSOR EE
 PARTS FROM " PLYWOOD
 TOP/BOTTOM 2 PCS. @ 7.875"x23.625
 SIDES 2PCS. 7.875"x
 DIVIDERS 8 PCS. @ VARIES"x
 WELLS 9 PCS. @ VARIES"x
 STABILIZER RIB 1 PC. @ 7.875"x23.625"
 (FROM ROUTER)

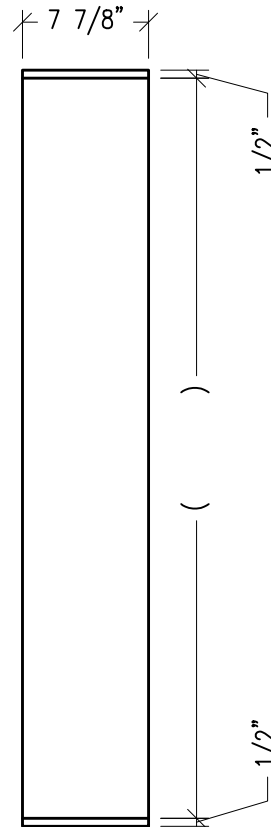

SIDE

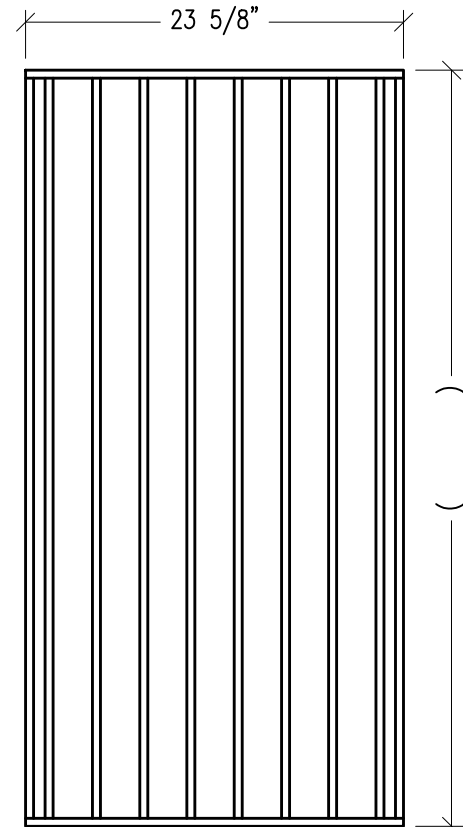

FRONT



99 SOUTH STREET, PASSAIC, NJ 07055
 (P) 973-916-1166 (E) estimating@rpgacoustic.com

Title: RPG MODFUSSOR EE
 CUTSHEET

Proj: RPG PRODUCT

Date: 8/24/22 By: JLP Scale: N15

Path: F:\Project Mgmt - RPG_RPG PRODUCTS\ALL PRODUCTS DRAWING\MODF_Modffusor\1-AutoCAD Drawings\Cutsheet\EE Cutsheet RI

Comments:

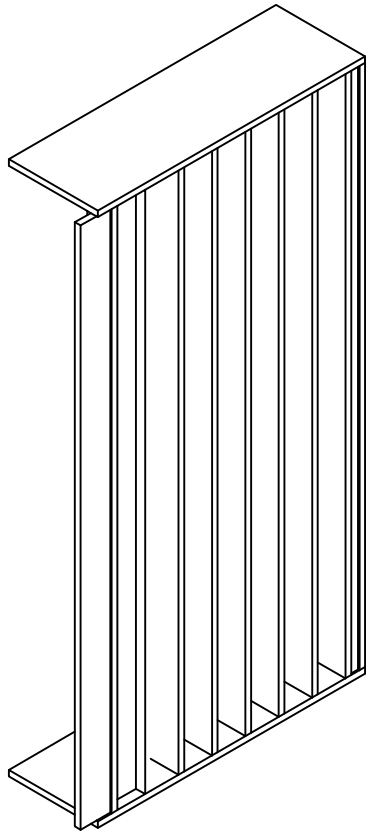

S.W. ISOMETRIC

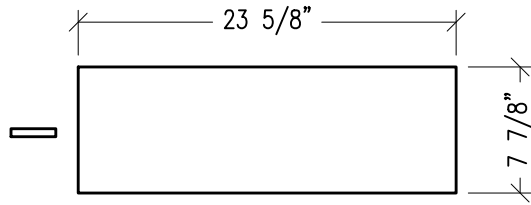

TOP

FINISH TYPE
VENEER

MODF – MODFUSSOR EJO
 PARTS FROM " PLYWOOD
 TOP/BOTTOM 2 PCS. @ 7.875"x23.625
 SIDES 1PCS. 7.875"x " "
 JOINER 1PCS. 2.8125"x " "
 DIVIDERS 8 PCS. @ VARIES"x " "
 WELLS 8 PCS. @ VARIES"x " "
 STABILIZER RIB 1 PC. @ 7.875"x23.625"
 (FROM ROUTER)

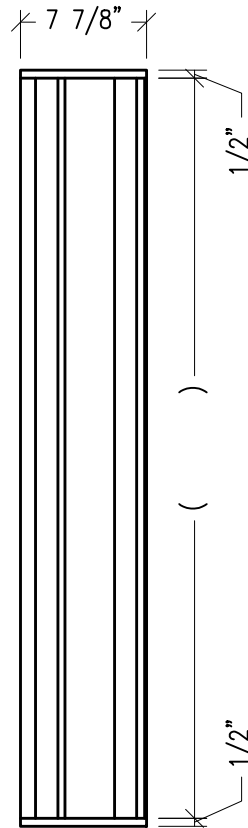

SIDE

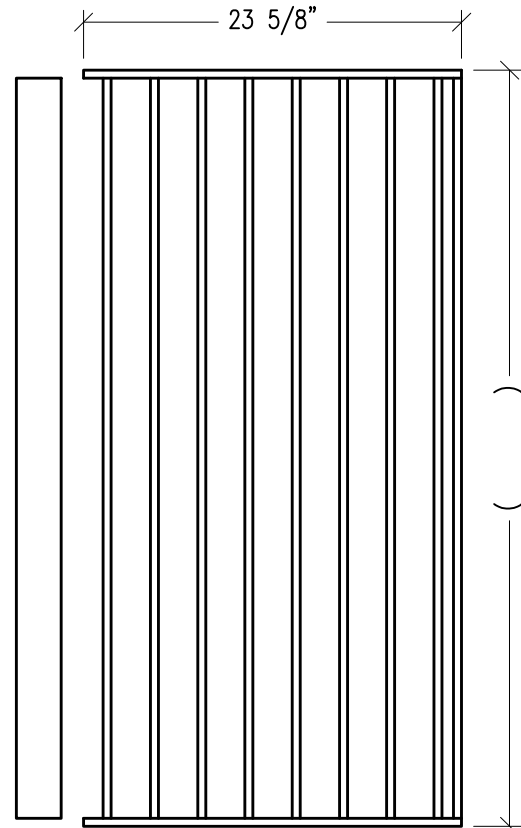

FRONT



99 SOUTH STREET, PASSAIC, NJ 07055
 (P) 973-916-1166 (E) estimating@rpgacoustic.com

Title: RPG MODFUSSOR EJO CUTSHEET

Proj: RPG PRODUCT

Date: 8/24/22 By: JLP Scale: N15

Path: F:\Project Mgmt - RPG\RPG PRODUCTS\ALL PRODUCTS DRAWING\MODF_Modffusor\1-AutoCAD Drawings\Cutsheet\EJO Cutsheet R1

Comments:

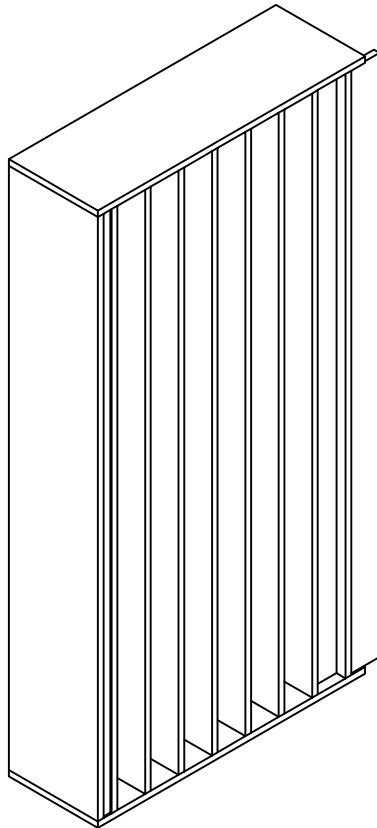

S.W. ISOMETRIC

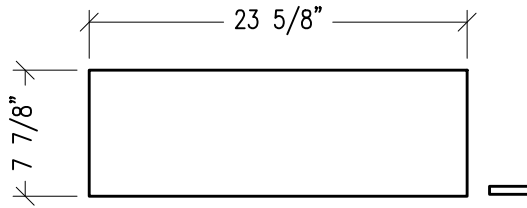

TOP

FINISH TYPE
VENEER

MODF – MODFUSSOR EJ1
 PARTS FROM " PLYWOOD
 TOP/BOTTOM 2 PCS. @ 7.875"x23.625
 SIDES 1PCS. 7.875"x
 JOINER 1PCS. 2.8125"x
 DIVIDERS 8 PCS. @ VARIES"x
 WELLS 8 PCS. @ VARIES"x
 STABILIZER RIB 1 PC. @ 7.875"x23.625"
 (FROM ROUTER)

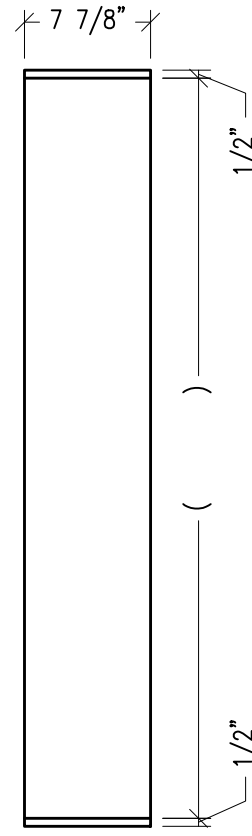

SIDE

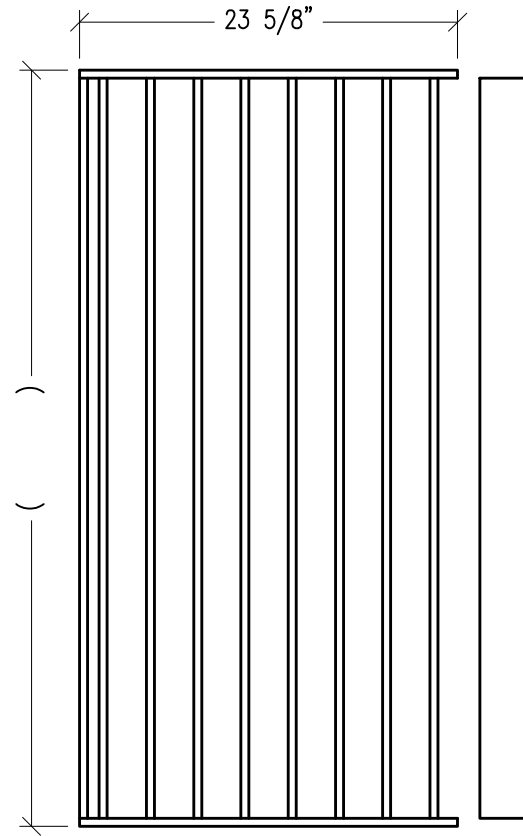

FRONT



99 SOUTH STREET, PASSAIC, NJ 07055
 (P) 973-916-1166 (E) estimating@rpgacoustic.com

Title: RPG MODFUSSOR EJ1
 CUTSHEET

Proj: RPG PRODUCT

Date: 8/24/22 By: JLP Scale: N15

Path: F:\Project Mgmt - RPG__RPG PRODUCTS\ALL PRODUCTS DRAWING\MODF_Modffusor\1-AutoCAD Drawings\Cutsheet\EJ1 Cutsheet R1

Comments:

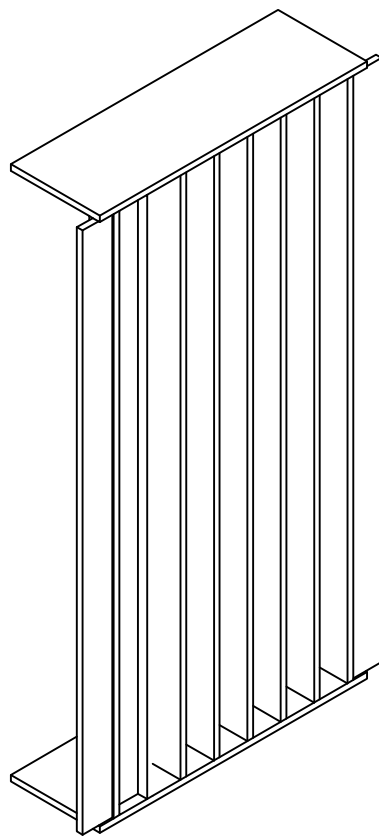

S.W. ISOMETRIC

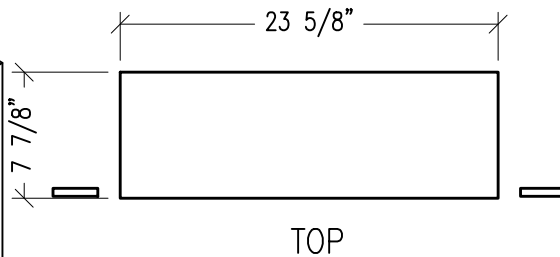

FINISH TYPE
VENEER

MODF - MODFUSSOR JJ
 PARTS FROM " PLYWOOD
 TOP/BOTTOM 2 PCS. @ 7.875"x23.625
 JOINER 2PCS. 2.8125"x
 DIVIDERS 8 PCS. @ VARIES"x
 WELLS 7 PCS. @ VARIES"x
 STABILIZER RIB 1 PC. @ 7.875"x23.625"
 (FROM ROUTER)

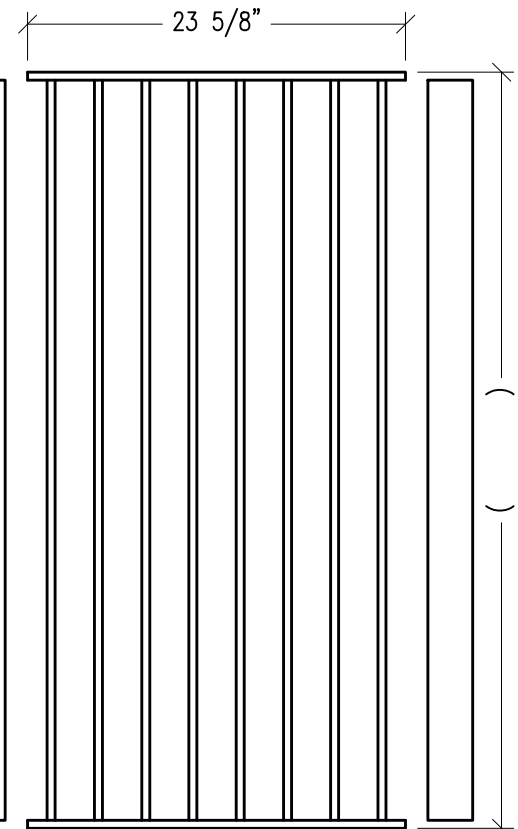
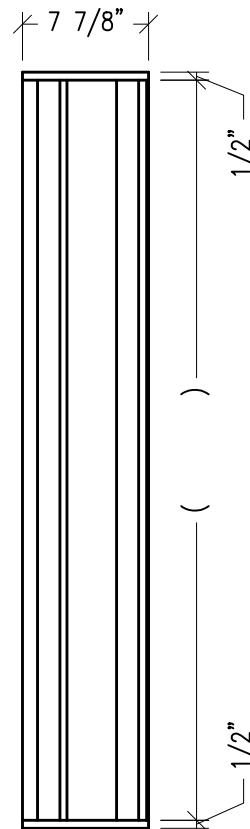

99 SOUTH STREET, PASSAIC, NJ 07055
 (P) 973-916-1166 (E) estimating@rpgacoustic.com

Title: RPG MODFFUSOR JJ
 CUTSHEET

Proj: RPG PRODUCT

Date: 8/24/22

By: JLP

Scale: N15

Comments:

Path: F:\Project Mgmt - RPG\PROJECTS\ALL PRODUCTS DRAWING\MODF_Modffusor\1-AutoCAD Drawings\Cutsheet\JJ Cutsheet.R1

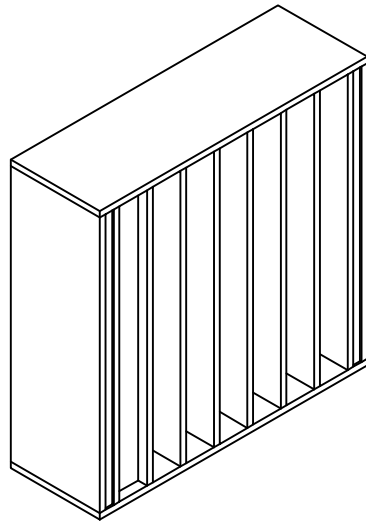

FINISH TYPE
VENEER

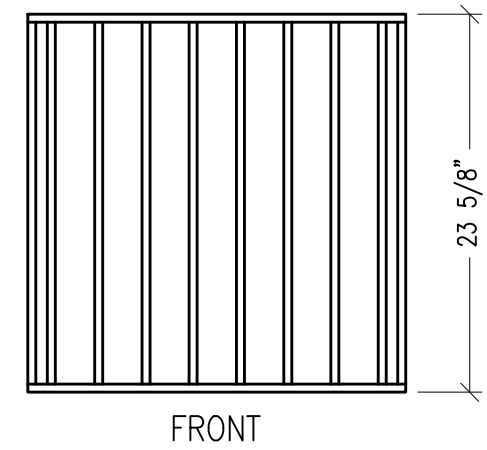
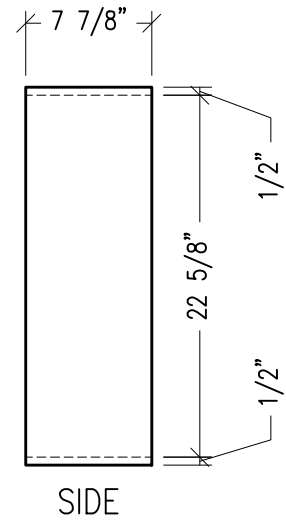
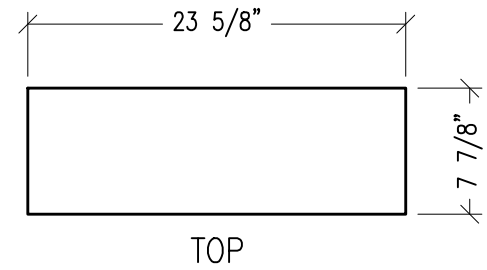

MODF - MODFUSSOR 2'x2' EE S.W. ISOMETRIC
 PARTS FROM " PLYWOOD
 TOP/BOTTOM 2 PCS. @ 7.875"x23.625
 SIDES 2PCS. 7.875"x22.625"
 DIVIDERS 8 PCS. @ VARIES"x22.625"
 WELLS 9 PCS. @ VARIES"x22.625"
 STABILIZER RIB 1 PC. @ 7.875"x23.625"(FROM ROUTER)



99 SOUTH STREET, PASSAIC, NJ 07055
 (P) 973-916-1166 (E) estimating@rpgacoustic.com

Title: RPG MODFUSSOR 2'x2' EE
 CUTSHEET

Proj: RPG PRODUCT

Date: 8/24/22

By: JLP

Scale: N15

Comments:

Path: F:\Project Mgmt - RPG\RPG PRODUCTS\ALL PRODUCTS DRAWING\MODF_Modffusor\1-AutoCAD Drawings\Cutsheet\2x2 EE Cutsheet RI

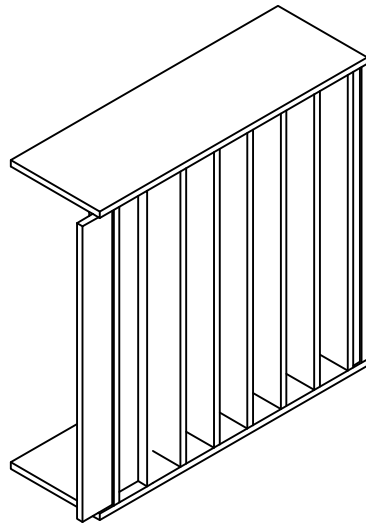

S.W. ISOMETRIC

MODF - MODFUSSOR 2'x2' EJO

PARTS FROM " PLYWOOD

TOP/BOTTOM 2 PCS. @ 7.875"x23.625"

SIDES 1PCS. 7.875"x22.625"

JOINER 1PCS. 2.8125"x22.625"

DIVIDERS 8 PCS. @ VARIES"x22.625"

WELLS 8 PCS. @ VARIES"x22.625"

STABILIZER RIB 1 PC. @ 7.875"x23.625"(FROM ROUTER)

FINISH TYPE
VENEER

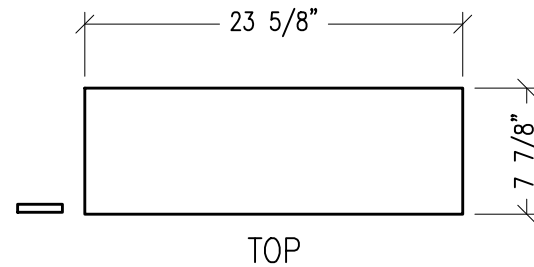

TOP

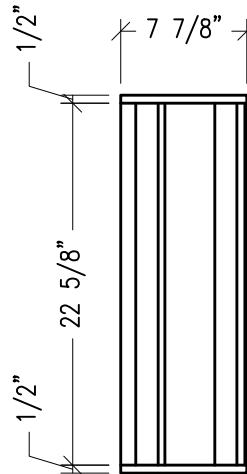

SIDE

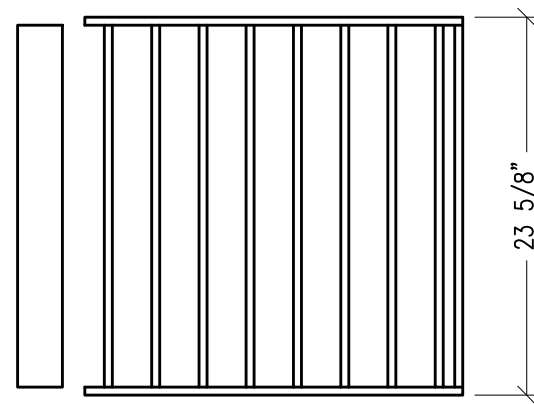

FRONT



99 SOUTH STREET, PASSAIC, NJ 07055
(P) 973-916-1166 (E) estimating@rpgacoustic.com

Title: RPG MODFUSSOR 2'x2' EJO
CUTSHEET

Proj: RPG PRODUCT

Date: 8/24/22 By: JLP Scale: N15

Path: F:\Project Mgmt - RPG\PROJECTS\ALL PRODUCTS DRAWING\MODF_Modfussor\1-AutoCAD Drawings\Cutsheet\2x2 EJO Cutsheet.RI

Comments:

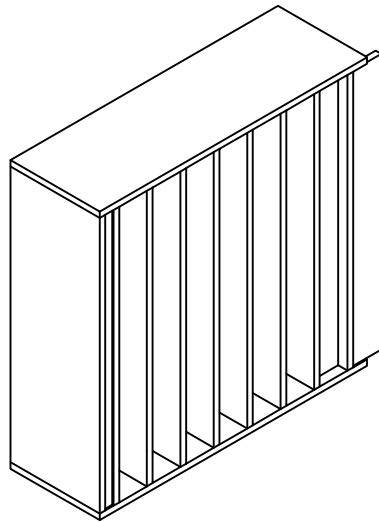

S.W. ISOMETRIC

MODF - MODFUSSOR 2'x2' EJ1

PARTS FROM " PLYWOOD

TOP/BOTTOM 2 PCS. @ 7.875"x23.625"

SIDES 1PCS. 7.875"x22.625"

JOINER 1PCS. 2.8125"x22.625"

DIVIDERS 8 PCS. @ VARIES"x22.625"

WELLS 8 PCS. @ VARIES"x22.625"

STABILIZER RIB 1 PC. @ 7.875"x23.625"(FROM ROUTER)

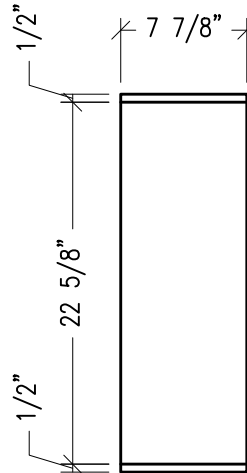

SIDE

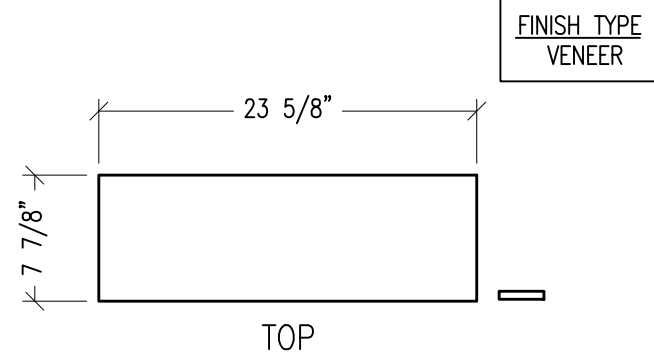

TOP

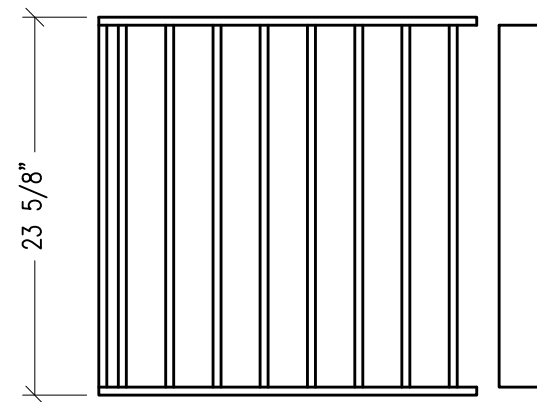

FRONT



99 SOUTH STREET, PASSAIC, NJ 07055
(P) 973-916-1166 (E) estimating@rpgacoustic.com

Title: RPG MODFUSSOR 2'x2' EJ1
CUTSHEET

Proj: RPG PRODUCT

Date: 8/24/22 By: JLP Scale: N15

Path: F:\Project Mgmt - RPG\PROJECTS\ALL PRODUCTS DRAWING\MODF_Modfussor\1-AutoCAD Drawings\Cutsheet\2x2 EJ1 Cutsheet R1

Comments:

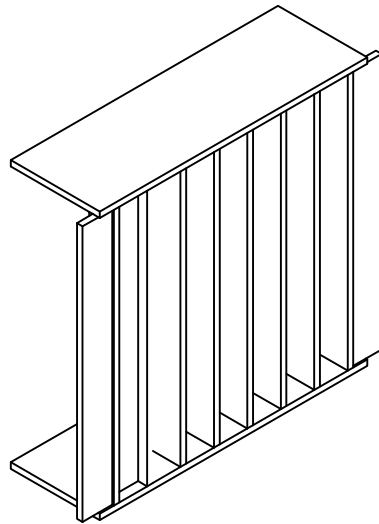

S.W. ISOMETRIC

MODF - MODFUSSOR 2'x2' JJ

PARTS FROM " PLYWOOD

TOP/BOTTOM 2 PCS. @ 7.875"x23.625"

JOINER 2PCS. 2.8125"x22.625"

DIVIDERS 8 PCS. @ VARIES"x22.625"

WELLS 7 PCS. @ VARIES"x22.625"

STABILIZER RIB 1 PC. @ 7.875"x23.625" (FROM ROUTER)

FINISH TYPE
VENEER

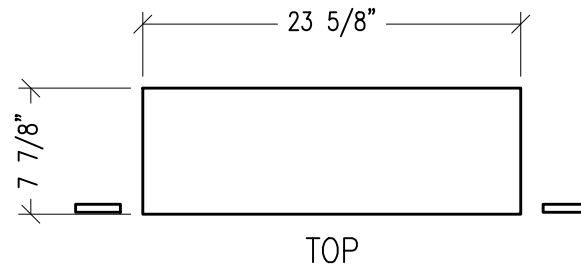

TOP

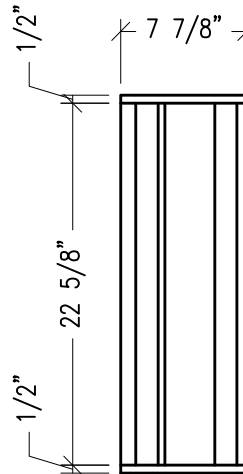

SIDE

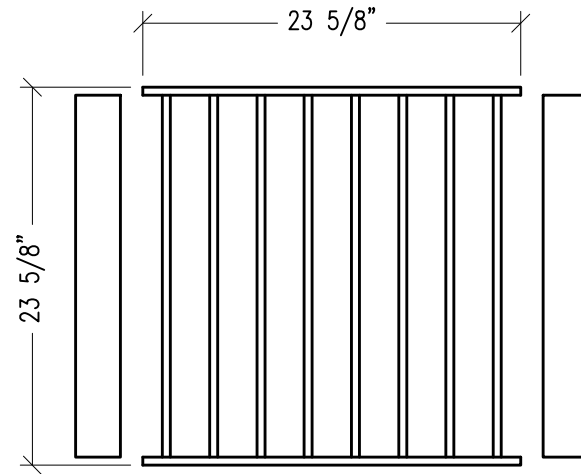

FRONT



99 SOUTH STREET, PASSAIC, NJ 07055
(P) 973-916-1166 (E) estimating@rpgacoustic.com

Title: RPG MODFUSSOR 2'x2' JJ
CUTSHEET

Proj: RPG PRODUCT

Date: 8/24/22

By: JLP

Scale: N15

Comments:

Path: F:\Project Mgmt - RPG\ - RPG PRODUCTS\ALL PRODUCTS DRAWING\MODF_Modfussor\1-AutoCAD Drawings\Cutsheet\2x2 JJ Cutsheet R1